

GUILDERLAND PUBLIC LIBRARY PHASING PLAN 2020-2021

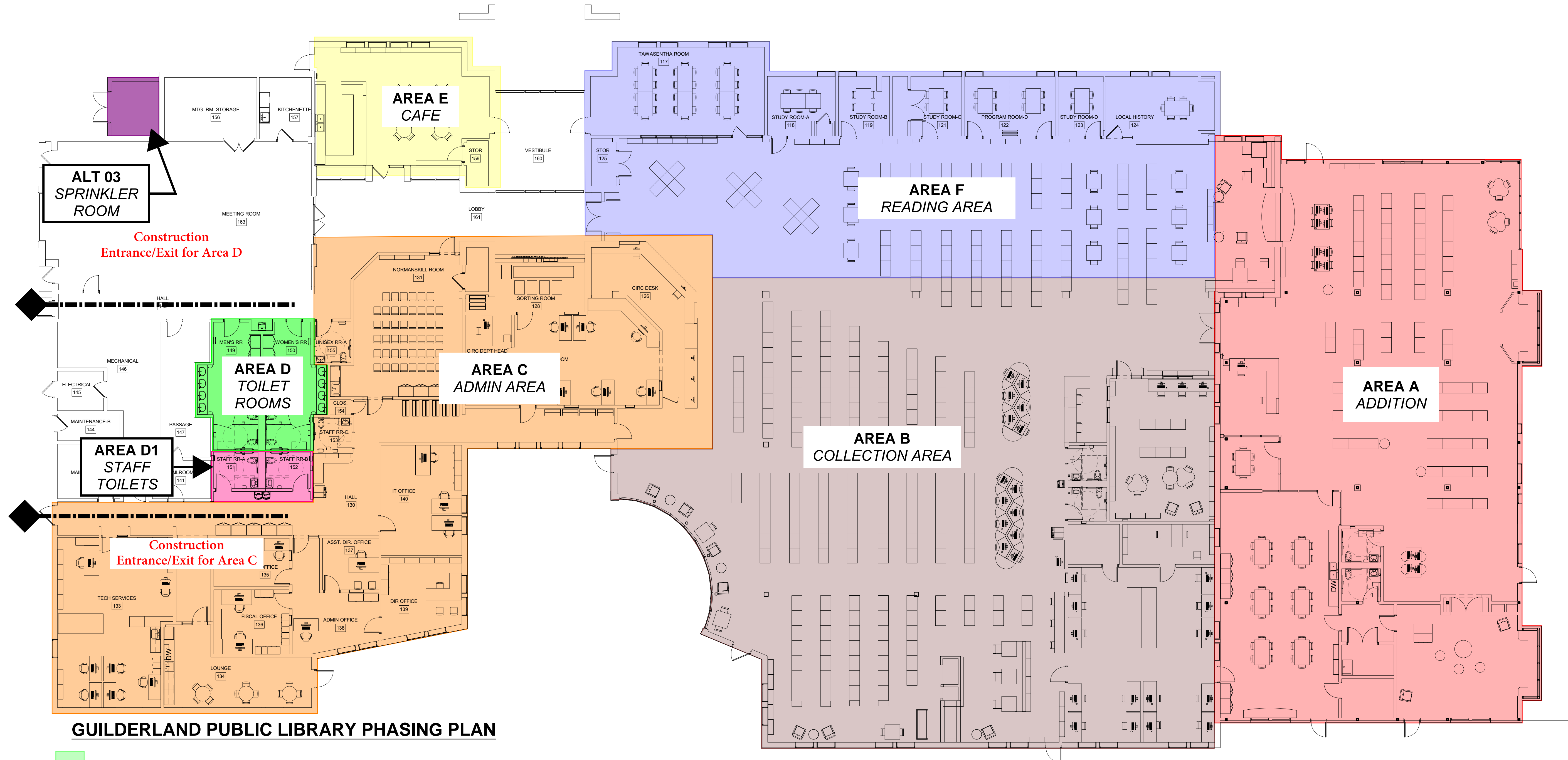

GUILDERLAND PUBLIC LIBRARY PHASING PLAN

- [20.1] AREA D: OCTOBER 2020 - FEBRUARY 2021
- [20.2] AREA A: OCTOBER 2020 - MAY 2021
- [20.3] ALT #03: OCTOBER 2020 - APRIL 2021
- [21.1] AREA C: JANUARY 2021 - MAY 2021
- [21.2] AREA D1: MARCH 2021 - MAY 2021
- [21.3] AREA E: MAY 2021
- [21.4] AREA F: MAY 2021 - AUGUST 2021
- [21.5] AREA B: JUNE 2021 - AUGUST 2021

General Notes:

1. Phasing Construction: Oct. 5, 2020 - Aug. 2021
2. Entire Existing building is to get sprinkler system
3. Exterior wall work to work on skylights, cleaning exterior walls and refinishing window frames.

© THIS DRAWING AND THE CONTENTS THEREOF ARE THE SOLE AND COPYRIGHTED PROPERTY OF BUTLER ROWLAND MAYS ARCHITECTS, LLP AND MAY NOT BE ALTERED, COPIED OR REPRODUCED BY ANY METHOD FOR ANY PURPOSE WITHOUT THE EXPRESS WRITTEN CONSENT OF BUTLER ROWLAND MAYS ARCHITECTS, LLP.

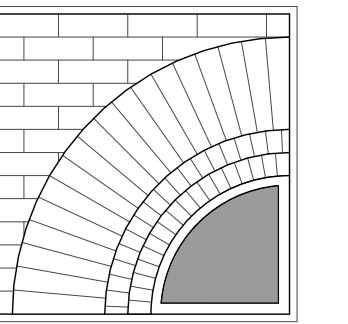

**BUTLER
ROWLAND
MAYS**
ARCHITECTS, LLP

57 West High Street
Ballston Spa
New York 12020

P: 518-885-1255
F: 518-885-1266
www.brmarchitects.com

ADDITION &
RENOVATIONS
for the

Guilderland
Public
Library

2228 Western Avenue,
Guilderland, NY 12084

SED PROJECT #:
01-08-02-06-6-014-012

PROJECT

CONSULTANT

CONSULTANT

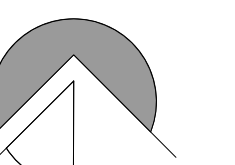

CALLED NORTH

EXHIBIT C
GPL - PH - 101
REV. 004: 09.02.2020
REV. 005: 09.15.2020
REV. 006: 09.17.2020

TITLE

DWG. NO.



GUILDERLAND PUBLIC LIBRARY SITE PHASING PLAN 2020-2021

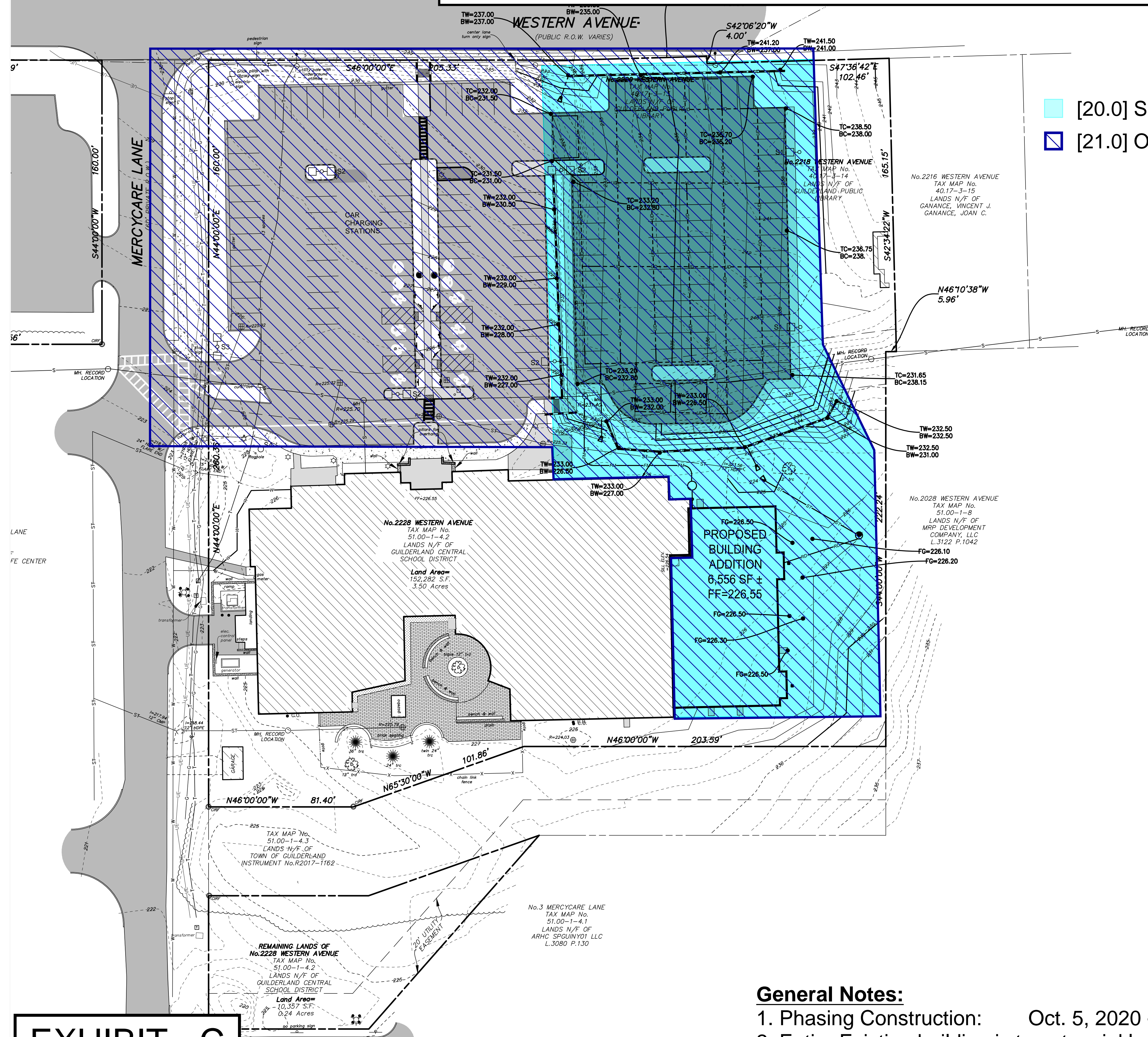

Guilderland Public Library Site Phasing

- [20.0] SITE PREP: FALL 2020
- [21.0] OVERALL SITE WORK: OCTOBER 2020 - SEPTEMBER 2021

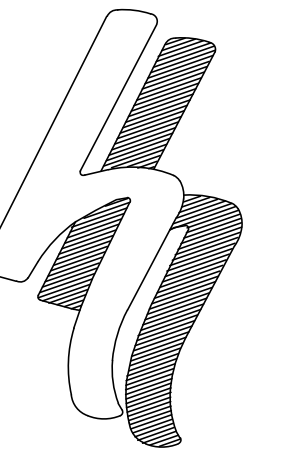

**HERSHBERG
&
HERSHBERG**
Consulting Engineers
and Land Surveyors
18 Locust Street
Albany, New York 12203

EXHIBIT C
GPL - PH - 101
REV. 004: 09.02.2020
REV. 005: 09.15.2020
REV. 006: 09.17.2020

EXHIBIT - C

Turner

General Notes:

1. Phasing Construction: Oct. 5, 2020 - Aug. 2021
2. Entire Existing building is to get sprinkler system
3. Exterior wall work to work on skylights, cleaning exterior walls and refinishing window frames.

